

A. Description

The Siemens PLM Software PACE Excellence in PLM Award will be presented to the top team at the 2016 PACE Annual forum for demonstrating and communicating the most effective use of NX design, simulation and Teamcenter software in their vehicles in support of PACE forum deliverables.

B. Event Plan

- Teams will be required to submit a written report explaining their use of the NX and Teamcenter software.
- The report should be written in Microsoft Word and should contain images or drawings of your work and be less than 1250 words long.
- The award will be presented at the PACE Awards dinner the evening of Thursday July 28th.
- The report should be submitted by 4PM ET on June 30, 2016 via email to jerry.sarfati@siemens.com

C. Team Instructions

The report should include:

- Explain how the newly design parts would be used and how they fit within existing geometry.
- Explain how you used NX CAD/CAE software as part of your development process. How you used NX for 3D modeling and documentation, simulation, etc. Describe the features in NX that you found useful in creating parts and assemblies. (See additional pictorial examples below.)
- How you used the Teamcenter software to manage your data.
- What went well and what could have been better? Include lessons learned.

Provide images or drawings of your design including the following:

- Document the design process of your new part(s) using images or drawings that show your progress from storyboard to finished design, using PNG, JPEG, GIF, or PDF files.
- Completed Part Design – Two or more images showing the new or modified parts
- Completed Assembly Design – Two or more images that give the viewer a complete idea of how assemblies are designed and will work
- Simulation – Two or more images that show simulations performed and the results on your assemblies.
- Data management - Two or more images that show how you manage and share product designs, documents, BOMs and data.

Example:

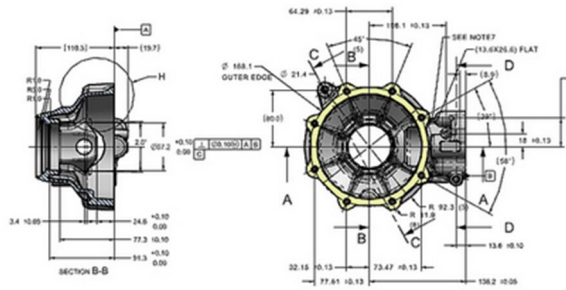

We used NX to change components in this way, so we were able to...

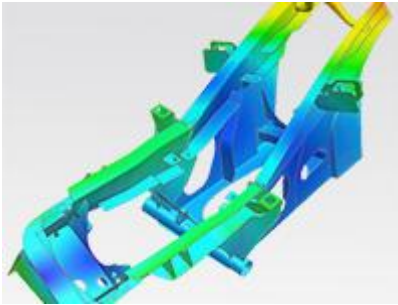

We validated the loads in NX Nastran by

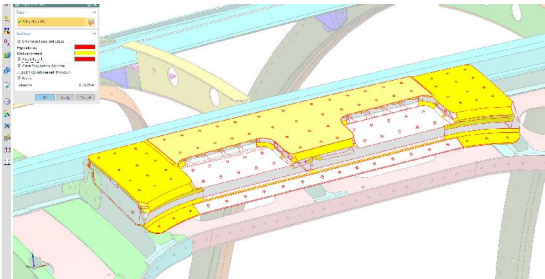

The software helped us identify a potential issue in this area. We solved the problem by

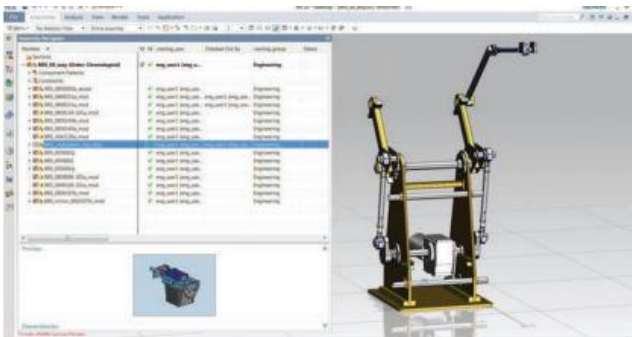

By using Teamcenter we learned how to manage

Each Siemens PLM judge will award teams with up to 20 points, based on the following criteria:

- Form --- Design Concept and Creativity (sketches and mock-ups)
- Fit --- Physical Model (realism, aesthetics, detail, supporting design, CAD graphics)
- Function --- Design Parameters, Performance and Validation plan (CAD Images, Stress results, Thermal validation, other test results)
- Presentation --- Effective, Professional, Credible Teamwork and Collaboration (Complexity of images, innovation, graphics Image clarity/high-quality resolution)

Judging Criteria (1 = Below Average, 2 = Average, 3 = Above Average, 4 = Excellent, 5 = Rave Review)

D.

Judges (offsite expert panel to judge technical reports)

- Subject matter experts from Siemens PLM Software.